

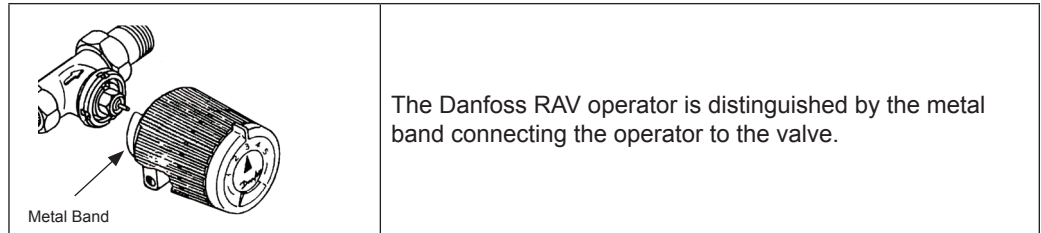







RAV to RA 2000:

In order to use current RA 2000 operators on existing systems with Danfoss RAV valves, the adapter 013G8072 must be installed to allow the new operator to fit onto the valve.

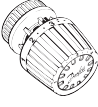

The Danfoss RAV operator is distinguished by the metal band connecting the operator to the valve.

Crossover Replacement Operator Guide, RAV to RA2000

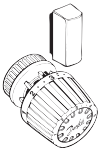
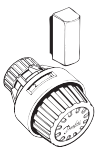
 013U8200 RAV 013U1100 RAVN	=	 013G8072 Adapter	+	 Built-in dial and sensor 013G8250	 Tamper resistant Built-in dial and sensor 013G8240
 013U8202 RAV 013U1102 RAVN	=	 013G8072 Adapter	+	 Built-in dial and remote sensor 013G8252	 Tamper resistant Built-in dial with remote sensor 013G2922

If replacing RAV valve mounted operator with an RA 2000 "Wall Mount" operator (013G8562, 013G8565, 013G8568 or 013G8564) this adapter IS NOT REQUIRED.

Installation:

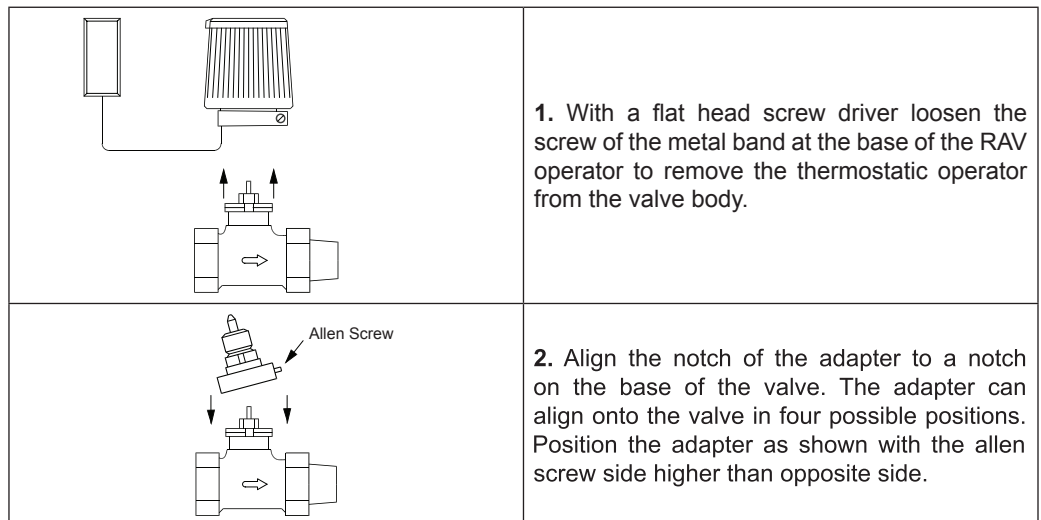

1. With a flat head screw driver loosen the screw of the metal band at the base of the RAV operator to remove the thermostatic operator from the valve body.

2. Align the notch of the adapter to a notch on the base of the valve. The adapter can align onto the valve in four possible positions. Position the adapter as shown with the allen screw side higher than opposite side.

Installation (Cont.):

	<p>3. Place adapter over the valve's shoulder as shown.</p>
	<p>4. Complete the mounting of the adapter and tighten the Allen screw.</p>
	<p>5a. For 013G8250 & 013G8252</p> <p>Align the base of the RA2000 operator with the notches on the adapter. Press firmly until an audible "click" is heard.</p>
	<p>5b. For 013G8240 & 013G2922</p> <p>For tamper resistant operators 013G2922 and 013G8240 the Allen screw on the operator must be tightened to secure to the valve.</p>

Operation Instructions:

For complete details of the installation of the operator, please consult instructions enclosed with applicable operator.

Danfoss can accept no responsibility for possible errors in printed materials and reserves the right to alter its products without notice. All trademarks in this material are property of the respective companies. Danfoss and Danfoss logotype are trademarks of Danfoss A/S. All rights reserved.



Danfoss Heating Segment
6711 Mississauga Road, Suite 306
Mississauga, ON, L5N 2W3
Tel.: 866-375-4822, Fax: 416-352-5981
www.heating.danfoss.us

Danfoss Heating Segment
11655 Crossroads Circle
Baltimore, MD 21220 USA
Tel.: 866-375-4822, Fax: 416-352-5981
www.heating.danfoss.us